

Round Flange Type FSBS Series

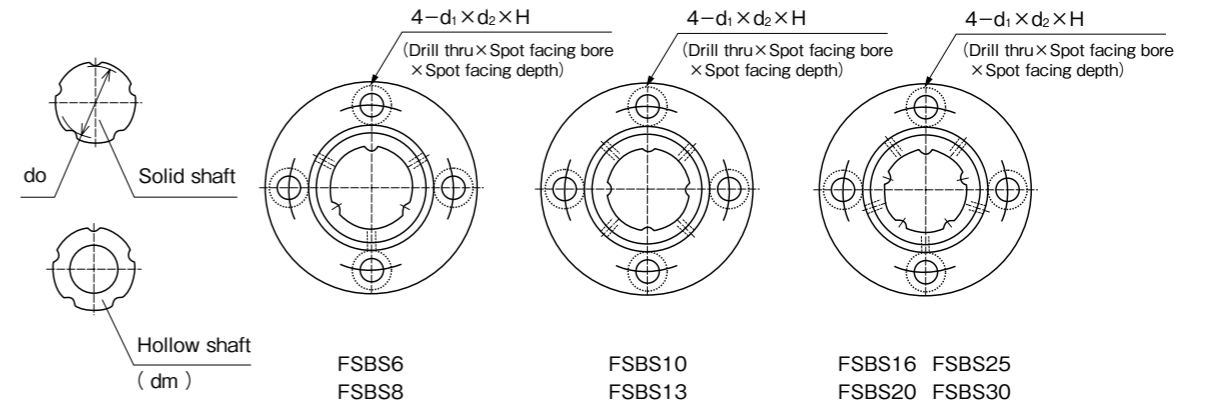
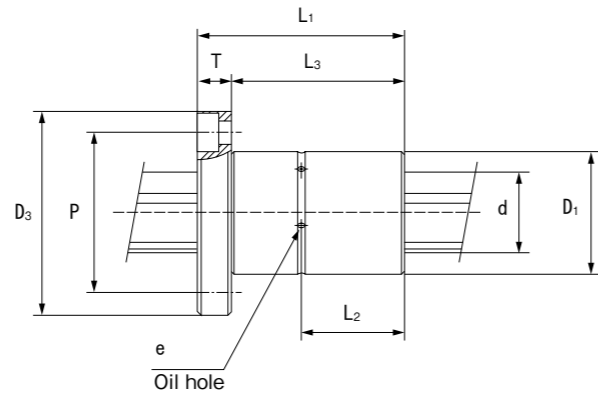

Shaft dia. (mm)	Model #		Outer dia.		Length L <sub>1</sub>	Dimensions of flange					H	L <sub>2</sub>	L <sub>3</sub>	Oil hole	Bore dia.
	No seal	With seals	D <sub>1</sub>	(h6)		D <sub>3</sub>	T	P	d <sub>1</sub>	d <sub>2</sub>				e	dm
6	FSBS 6	FSBS 6UU	14	0 -0.011	25	30	6	22	3.5	6	3.1	12.5	19	1.5	2
8	FSBS 8	FSBS 8UU	16		25	32	6	24	3.5	6	3.1	12.5	19	1.5	3
10	FSBS10	FSBS10UU	21	0 -0.013	33	41	8	30	4.5	8	5.3	16.5	25	1.5	4
13	FSBS13	FSBS13UU	24		36	45	8	34	4.5	8	5.3	18	28	1.5	4
16	FSBS16	FSBS16UU	31	0 -0.016	41	52	8	40	4.5	8	5.3	20.5	33	1.5	6
20	FSBS20	FSBS20UU	35		46	60	10	46	5.5	9.5	6.3	23	36	2	8
25	FSBS25	FSBS25UU	42		60	68	10	54	5.5	9.5	6.3	30	50	2	12
30	FSBS30	FSBS30UU	47		66	77	12	60	6.6	12.5	7.6	33	54	2.5	17

Minor dia. do	Number of grooves	Basic rated radial load (kN)		Basic rated torque (N · m)		Static rated moment (N · m)		Weight (kg)		Dia. (h7) d
		Dynamic Cr	Static Cor	Dynamic Ct	Static Cot	Mpo- I	Mpo- II	Shaft / m	Sleeve	
5.6	3	1.2	2.1	3.8	7	5	36	0.23	0.03	6
7.6		1.2	2.1	4.8	8.7	5	36	0.39	0.04	8
10	4	2.4	4.3	11	21	15	102	0.65	0.1	10.4
13		3.3	5.9	20	37	22	148	1.11	0.11	13.4
16	5	3.8	6.9	32	58	32	216	1.65	0.19	16.6
20		4.6	8.3	46	84	42	276	2.57	0.28	20.6
25		10.8	19.4	135	244	113	773	4.04	0.37	25.8
30		12.3	22.2	181	327	136	937	5.85	0.52	30.8

Code Name

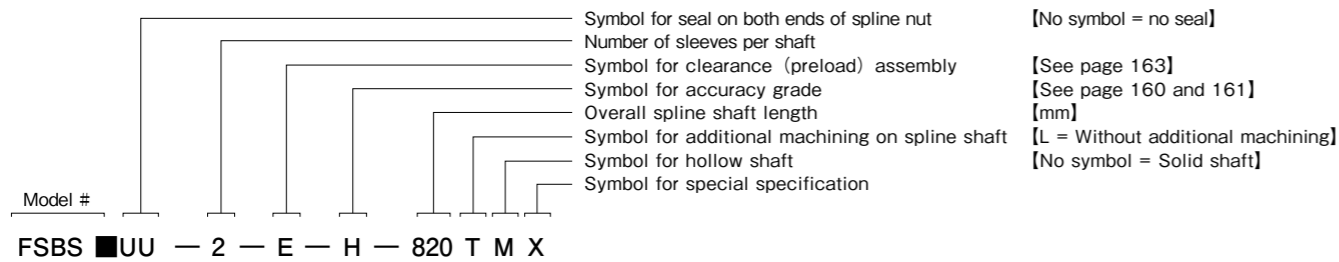

- Note 1) Spline nut and shaft are supplied as a matched set.  
2) See page 164 for fitting dimensions between spline nut and housing box.  
3) See page 164 for detailed dimensions of keyway and key.